

C.NO. : 384/ 2024 / HRO /H1

REF NO:12305/136 Of the E-Panchayat DTLP.

REF NO:12305/232 Of the E-Panchayat

Revised DTLP .

Revised DTLP NO.39/2024 /HRO /H1

(This revises DTLP:29/2024/HRO/H1dt17-05-2024)



KISHAN NAGAR G.P  
EXTRACT OF VILLAGE MAP

SITE U/R :

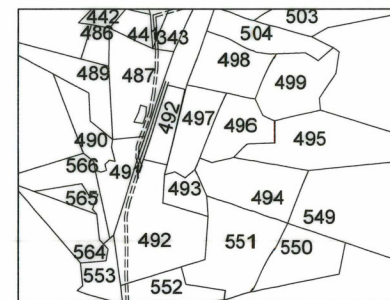

#### REFERENCE:

LAYOUT BOUNDARY	
EXISTING ROADS	
PROPOSED ROADS	
MORTGAGE AREA	

#### AREAS:

TOTAL LAYOUT AREA	: Ac. 4-15.00 Gts	Or 21175.00 Sqyds.
SITE RESERVED FOR OPEN SPACE (PARK) (10.0%)	: Ac. 0-17.50 Gts	Or 2117.50 Sqyds.
ROADS AREA (29.54%)	: Ac. 1-11.70 Gts	Or 6255.70 Sqyds.
PLOTTED AREA (60.46%)	: Ac. 2-25.80 Gts	Or 12801.80 Sqyds.
NO. OF PLOTS	: 62 Nos.	
MORTGAGE AREA (16.02% OF PLOTTED AREA)	: 2051.13 Sq yds	
PLOT NOs.48 to 51 & 59 to 62		

#### CAUTION:

THIS LAYOUT IS LEGALLY VALID ONLY ON ITS RELEASE / APPROVAL BY THE CONCERNED GRAMPANCHAYAT UNDER SECTION 113(b) OF TELANGANA PANCHAYAT RAJ ACT 2018 (Act no.5/2018) AS COMMENCEMENT WIDE G.O.Ms. No.22 PR & RD Dt:18-04-2018 AND UNDER RULE 11 (3) OF G.O.67 PR&RD ,DT:26-02-2002 ON FULFILLMENT OF ALL LAYOUT CONDITIONS. ANY TRANSACTION OF MORTGAGE AREA PRIOR TO THE ABOVE IS ILLEGAL.

## KISHAN NAGAR GRAMPANCHAYAT

REVISED DRAFT TECHNICAL LAYOUT PATTERN FOR THE RESIDENTIAL PLOTS IN SY.NO. 492/P SITUATED AT AT KISHAN NAGAR G.P, & (V), FAROOQNAGAR (M), RANGAREDDY DIST. BELONGS TO: A.VENKAT REDDY S/O. A.PADMA REDDY  
SCALE 1"=66"

ASSISTANT DIRECTOR

A.D.M.

REGIONAL DEPUTY DIRECTOR OF TOWN AND COUNTRY PLANNING, HYD