

C.NO: 968 / 2023 / HRO/H1

REF NO:20036/2477 Of the E-Panchayat.

DTLP NO.100 / 2023 /HRO /H1

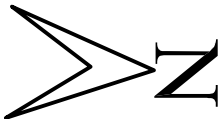

CHOWDAMMAGUDA THANDA G.P

EXTRACT OF ILUP  
SITE UR :

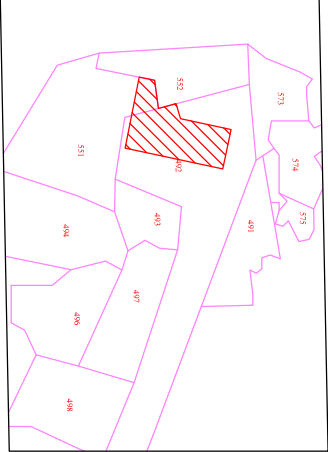

REFERENCE:

- LAYOUT BOUNDARY
- EXISTING ROADS
- PROPOSED ROADS

AREAS:

TOTAL LAYOUT AREA	: Ac. 4-39.00 Gls Or 24079.00 Sq.yds.
SITE RESERVED FOR OPEN SPACE (PARK) (10.0 %)	: Ac. 0-19.90 Gls Or 2407.90 Sq.yds.
ROADS AREA (30.00%)	: Ac. 1-19.48 Gls Or 7197.08 Sq.yds.
PLOTTED AREA (60.00%)	: Ac. 2-39.80 Gls Or 14474.20 Sq.yds.
NO. OF PLOTS	: 66 Nos.
MORTGAGE AREA (15.25% OF PLOTTED AREA) PLOT NOS. 31 to 36	: 2203.27 Sq.yds.

CAUTION:

THIS LAYOUT IS LEGALLY VALID ONLY ON ITS RELEASE/APPROVAL BY THE CONCERNED GRAMPANCHAYAT UNDER SECTION 113 OF TELANGANA LAND REVENUE ACT, 1948. NO TRANSACTION OF MORTGAGE AREA PRIOR TO THE ABOVE IS LEGAL.

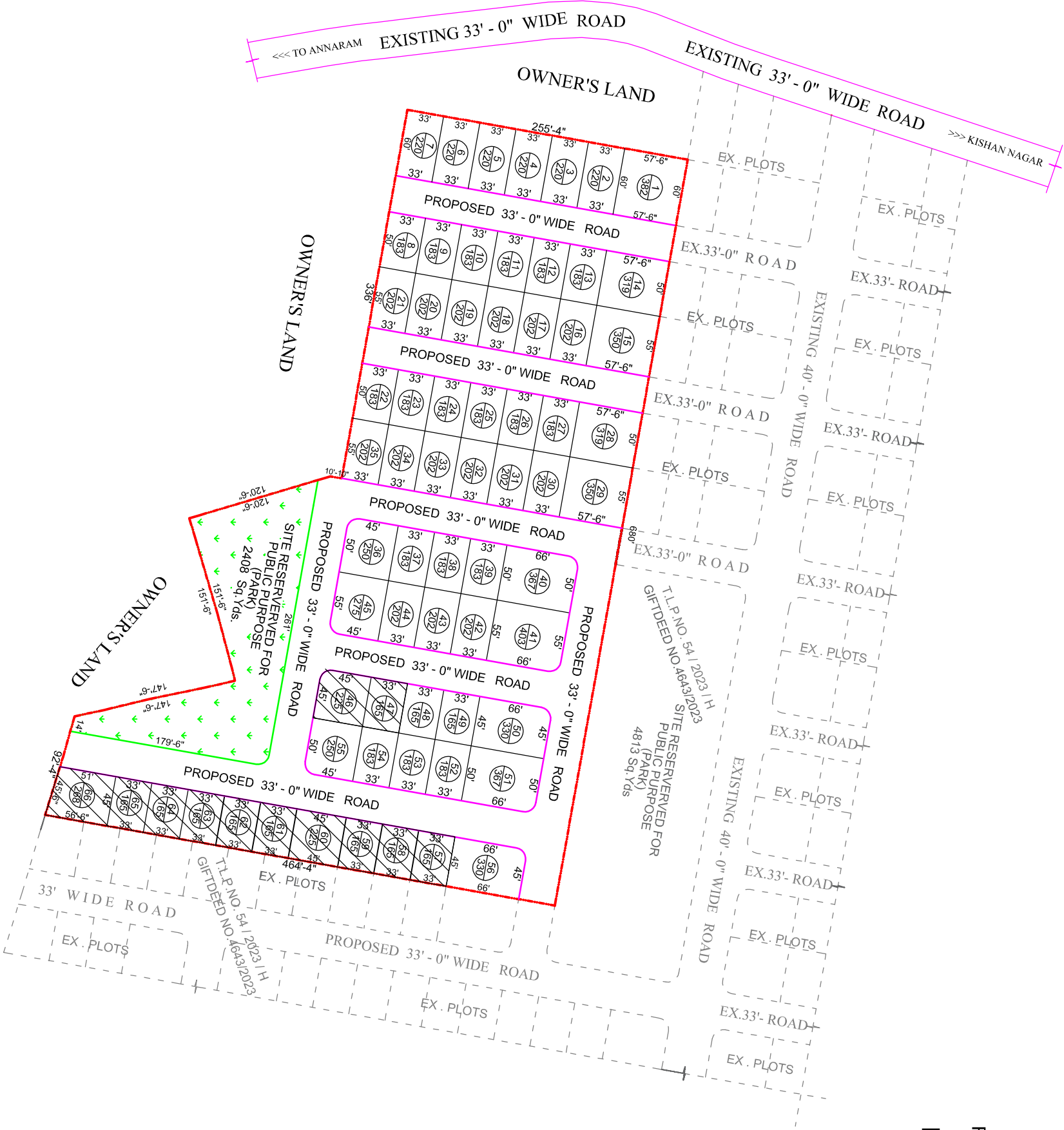

CHOWDAMMAGUTTA THANDA GRAMPANCHAYAT

DRAFT TECHNICAL LAYOUT PATTERN FOR THE RESIDENTIAL PLOTS IN SY.NOS.492/P & 551/P SITUATED AT CHOWDAMMAGUTTA G.P & KISHAN NAGAR REVENUE VILLAGE, FAROOQNAGAR MANDAL AND RANGA REDDY DIST. BELONGS TO M/S. RAJ BREEDERS & HATCHERIES PRIVATE LIMITED, REPRESENTED BY ITS MANAGING DIRECTOR SRI. GAURAV KHURANA. SCALE 1"=66"